

St. Lucia

51'0"

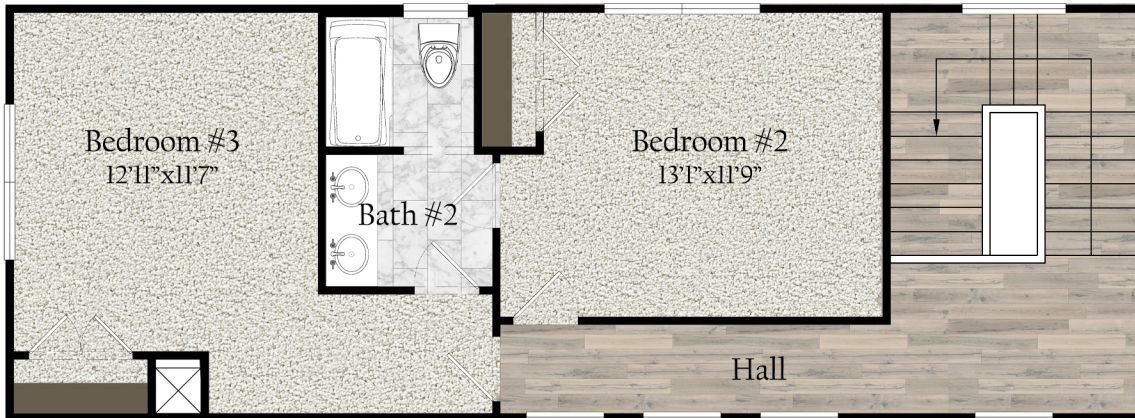

Front Elevation



1st Floor Conditioned	2,040
2nd Floor Conditioned	701
Total Heated:	2,741
Garage #1	283
Garage #2	252
Covered Entry	33
Covered Veranda	99
Covered Breezeway	63
Total Under Roof:	3,471
Open Courtyard	735

This home plan illustration is conceptual and may vary in detail from the formal plans and specifications, and is not drawn to scale. All square footage and room dimensions are approximate and cannot be guaranteed. Model homes may include fixtures, fittings, equipment, features, materials, and/or options that may vary from standard plans. Options are available at additional cost. All home prices, final design, plan dimensions, architectural or other features, fixtures and fittings, equipment and other materials, and specifications are subject to change at any time without prior notice or obligation. Changes may result from Kingfish Bay Development, LLC's (the "Developer") ongoing program of design improvement, actual building conditions or the lot within the Development on which this home plan may be constructed or otherwise. Prices for this home plan do not include any applicable lot premium. This handout is for illustration purposes only, is NOT part of any legal document, does not subject the Developer to any legal obligation or liability and is not to be relied on in entering into the Lot Sale and Construction Agreement or any other agreement relating to the home. Any final specifications shall be included, or referenced in the Lot Sale and Construction Agreement should you proceed to purchase a lot within the Development. You are strongly advised to review in detail the terms of the Lot Sale and Construction Agreement presented to you, and the lot and home plans attached thereto prior to purchasing a lot, and, subsequently, any agreed Selections Lists and to take the necessary, independent legal or other professional advice, and to undertake the necessary diligence of the lot, home plan and the specifications to ensure that any specifications stated therein meet with your requirements. This illustration, and all rights therein are the exclusive property of the Developer and may not, without the Developer's prior written consent in each case, be used, reproduced or copied other than for the legitimate purpose of considering the purchase of, or purchasing a lot in the Development.

